

Features

FS Value Series batteries are:

- Engineered to deliver highest value possible with consistent, dependable power meeting rated capacities
- 3-5 year service life in normal standby applications at consistent 25° C temperatures
- Valve Regulated Lead Acid (VRLA), Absorbent Glass Mat (AGM) Technology – Safe operation in any position
- Lead-calcium alloy grids and the use of high purity virgin lead
- Externally sealed Flame retardant ABS case and cover to UL94-HB specifications
- UL recognized (UR) as a component in UL approved equipment installations under File number MH46202
- Classified as non-spillable status for transportation making it non-hazardous for normal transportation processes. Approved for transport by air. Fulfills US D.O.T., I.A.T.A., F.A.A., C.A.B. handling and shipping requirements
- For more details on special design and construction details see Features and Benefits publication on www.oraclebattery.com



Specification

Cell per unit	3	Ambient Temperature
Nominal Voltage (V)	6	Charge 0°C (32°F) to 40°C (104°F)
Nominal Capacity (Ah)	8.5Ah @ 20 hour rate to 1.75vpc	Discharge -15°C (5°F) to 50°C (122°F)
Weight	Approx. 1.45kg (3.20Lbs.)	Storage -15°C (5°F) to 40°C (104°F)
Internal Resistance (1KHz)	16mΩ	Max Charge Current
Max Discharge Current (5s)	120A	Max charge current 2.55A
Battery Life	Stand by : 3~5 years	Cycle use: Charge voltage: 7.2 to 7.5V
Terminal Type	F1/F2	Stand by: Charge voltage: 6.75 to 6.90V
Container Material	ABS 94-HB flame retardant case (94V-0 Optional)	



Dimensions

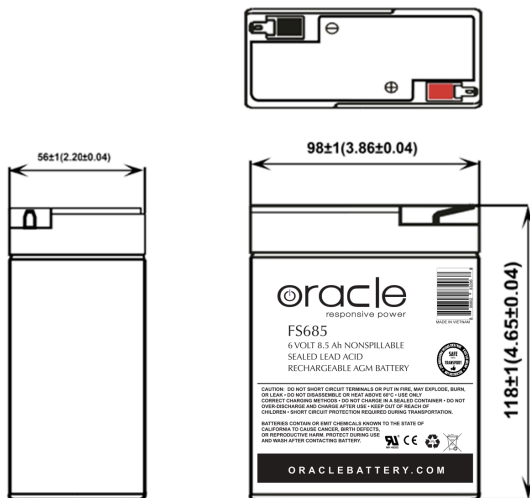

	Length	Width	Height	Total Height
Unit mm	98±1	56±1	118±1	118±1
Unit inch	3.86±0.04	2.20±0.04	4.65±0.04	4.65±0.04

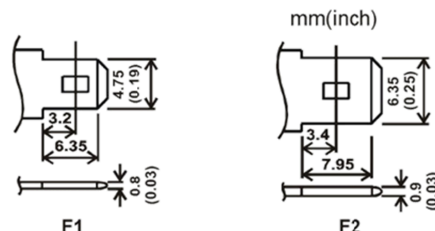

Terminal Voltage



Discharge Times

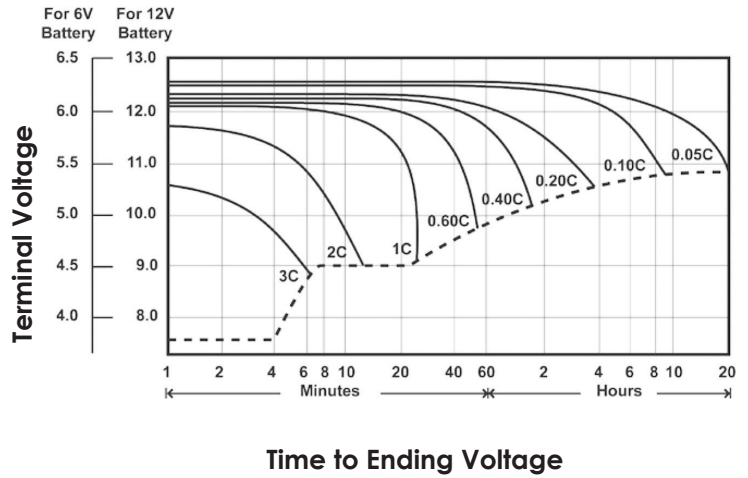

Charge Voltages

Temperature Compensated Charging	Average Temperature	Cycle Charging Volts Per Cell	Float Charging Volts Per Cell
	-40°C (-40°F)	2.85-2.95	2.38-2.43
	-20°C (-4°F)	2.67-2.77	2.34-2.39
	-10°C (14°F)	2.61-2.71	2.32-2.37
	0°C (32°F)	2.55-2.65	2.30-2.35
	10°C (50°F)	2.49-2.59	2.28-2.33
	20°C (68°F)	2.43-2.53	2.26-2.31
	25°C (77°F)	2.40-2.50	2.25-2.30
	30°C (86°F)	2.37-2.47	2.24-2.29
	40°C (104°F)	2.31-2.41	2.22-2.27
50°C (122°F)	2.25-2.35	2.20-2.25	

Temperature Storage

Average Storage Temperature	Recharging Interval
68°F	Every 9 months
77°F	Every 6 months
95°F	Every 3 months

Constant Current Discharge Characteristics (25°C 77°F)

F.V/Time	5MIN	15MIN	30MIN	60MIN	2HR	3HR	5HR	8HR	10HR	20HR
1.60V	33.00	16.20	9.80	5.35	3.10	2.39	1.530	1.030	0.855	0.455
1.67V	20.00	15.30	9.30	5.30	2.99	2.35	1.520	1.020	0.850	0.453
1.70V	27.20	14.50	8.80	5.20	2.95	2.24	1.480	1.010	0.830	0.451
1.75V	24.70	13.60	8.45	5.04	2.88	2.19	1.450	0.990	0.815	0.450
1.80V	21.80	12.40	8.15	4.82	2.78	2.15	1.410	0.975	0.795	0.435